

## **Appendix I                      Volume 2 plans**

### **I.9                      Features of the Historic Environment Plan**

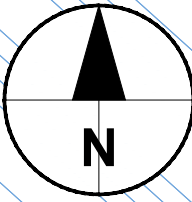
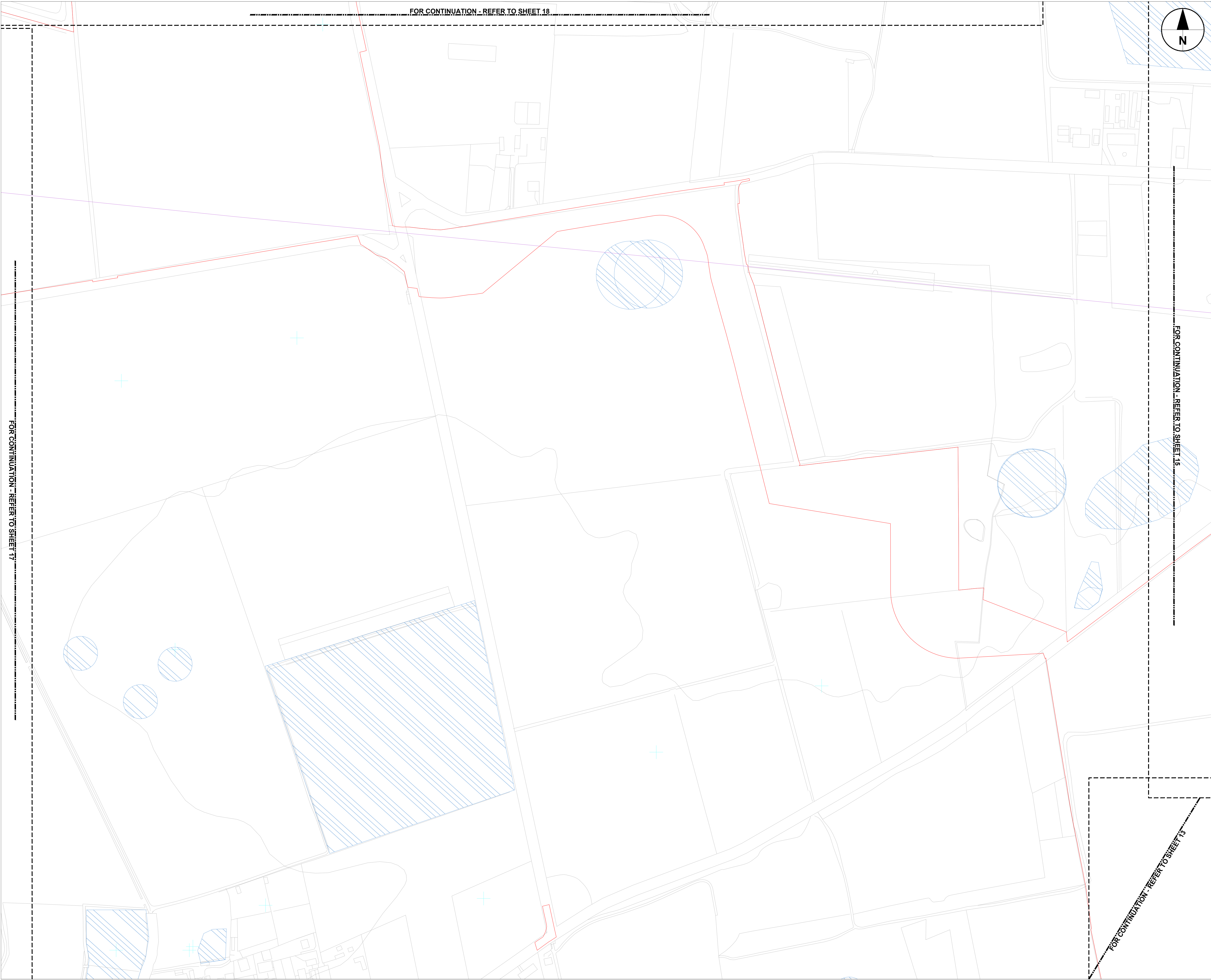

- KEY:
- Order limits
  - Conservation Areas
  - Listed Buildings
  - Registered Parks and Gardens
  - Scheduled Monument
  - HER Monument - Point
  - HER Monument - Linear
  - HER Monument - Area

Notes:  
This is a high-level plan showing heritage assets in the area. More detailed plans are provided in the Environmental Statement [EN010106/APP/6.3] to 'Further information on heritage assets is also included in the Environmental Statement Figures [EN010106/APP6/3].

Copyright:  
Contains OS data © Crown copyright and database right 2021  
Contains public sector information licensed under the Open Government Licence v3.0  
NOTE:  
Document Reference: EN010106/APP/2.8  
APFP Regulation: 5(2)(o)

Purpose of Issue  
**FOR DCO SUBMISSION**

Client  
**SUNNICA LTD**



Drawing Title  
**STATUTORY AND NON-STATUTORY SITES  
OR FEATURES OF THE HISTORIC  
ENVIRONMENT PLAN  
SHEET 16 OF 24**

Drawn LE	Checked AD	Approved NC	Date 25/08/22
AECOM Internal Project No. 60589004		Scale @ A3 1:2500	
THIS DOCUMENT HAS BEEN PREPARED PURSUANT TO AND SUBJECT TO THE TERMS OF AECOM'S APPOINTMENT BY ITS CLIENT. AECOM ACCEPTS NO LIABILITY FOR ANY USE OF THIS DOCUMENT OTHER THAN BY ITS ORIGINAL CLIENT OR FOLLOWING AECOM'S EXPRESS AGREEMENT TO SUCH USE, AND ONLY FOR THE PURPOSES FOR WHICH IT WAS PREPARED AND PROVIDED.			
AECOM Unit 1 Wellbrook Court, Girton, Cambridge, CB3 0NA United Kingdom Telephone (01223) 488000 www.aecom.com			
Drawing Number EN010106/APP/2.8			Rev 1